

RIVETS AND BURRS

COPPER BELT RIVETS AND BURRS



RIVETS: 1 LB/PACK, BURRS: 1 LB/PACK

Size	Length							Burrs
	3/8"(*)	1/2"	5/8"	3/4"	1"	1 1/4"	1 1/2"	
7	-	FS-#07-050	FS-#07-063	FS-#07-075	FS-#07-100	FS-#07-125	FS-#07-150	FS-#07-BUR
8	FS-#08-038	FS-#08-050	FS-#08-063	FS-#08-075	FS-#08-100	FS-#08-125	FS-#08-150	FS-#08-BUR
9(*)	FS-#09-038	FS-#09-050	FS-#09-063	FS-#09-075	FS-#09-100	FS-#09-125	FS-#09-150	FS-#09-BUR
10	FS-#10-038	FS-#10-050	FS-#10-063	FS-#10-075	FS-#10-100	FS-#10-125	FS-#10-150	FS-#10-BUR
11(*)	FS-#11-038	FS-#11-050	FS-#11-063	FS-#11-075	FS-#11-100	FS-#11-125	FS-#11-150	FS-#11-BUR
12	FS-#12-038	FS-#12-050	FS-#12-063	FS-#12-075	FS-#12-100	FS-#12-125	FS-#12-150	FS-#12-BUR
13(*)	FS-#13-038	FS-#13-050	FS-#13-063	FS-#13-075	FS-#13-100	-	-	FS-#13-BUR
14	FS-#14-038	FS-#14-050	FS-#14-063	FS-#14-075	FS-#14-100	-	-	FS-#14-BUR

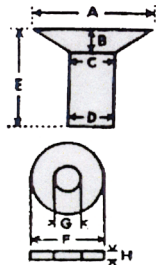

A = Head Diameter
 B = Head Thickness
 C = Diam. under Head
 D = Shank Tip Diam.
 E = Overall Length
 F = Outside Diameter
 G = Inside Diameter
 H = Thickness

Size (Inches)	7	8	9	10	11	12	13	14
Diameter of Head (A)	9/16	1/2	15/32	7/16	13/32	3/8	11/32	5/16
Thickness of Head (B)	0.070	0.063	0.058	0.055	0.050	0.045	0.040	0.030
Diameter under Head (C)	0.191	0.181	0.161	0.151	0.141	0.137	0.118	0.102
Diameter Tip of Shank (D)	0.175	0.165	0.145	0.137	0.127	0.123	0.105	0.092
Outside Diameter (F)	0.500	0.469	0.438	0.406	0.391	0.360	0.344	0.313
Inside Diameter (G)	0.176	0.166	0.146	0.138	0.128	0.124	0.106	0.093
Thickness (H)	0.051	0.045	0.040	0.036	0.031	0.028	0.025	0.022

Length of Rivet	APPROXIMATE NUMBER OF RIVETS, BURRS PER POUND							
	7	8	9	10	11	12	13	14
3/8"	-	206	260	302	350	412	510	702
1/2"	142	180	208	256	290	330	420	579
5/8"	127	150	183	216	250	287	360	490
3/4"	112	133	160	192	215	244	300	435
1"	89	105	129	147	170	191	250	336
1 1/4"	74	86	108	121	140	160	-	-
1 1/2"	62	75	93	104	125	136	-	-
Burrs	380	465	580	750	950	1240	1350	2050

(*) Not kept in stock. Minimum order quantity required.

RIVETS AND BURRS

COPPER BELT RIVETS AND BURRS

Nickel Plated.

RIVETS: 1 LB/PACK		
Reference	Size	Dimension
FL-886850	8	3/4"
FL-886851	8	1 1/4"
FL-886848	9	3/4"
FL-886849	9	1 1/4"
FL-886852	10	3/4"
FL-886853	10	1 1/4"
FL-886854	12	1"
FL-886856	14	3/4"

BURRS: 0.5 LB/PACK	
Reference	Size
FL-887859	8
FL-887860	9
FL-887861	10
FS-#12NP-BU	12
FL-887864	14



STAINLESS STEEL RIVETS

Annealed.

THIN, FLAT OVAL HEAD, 100 U./PACK	
Reference	Dimensions
FL-886870	1/8" x 5/8"
FL-886871	5/32" x 1/4"
FL-886873	5/32" x 11/32"
FL-88682	5/32" x 5/8"
FL-886869	5/32" x 1"
FL-886874	3/16" x 3/8"
FL-886876	3/16" x 9/16"



90 COUNTER HEAD SUNK, 100 U./PACK	
Reference	Dimensions
FL-886881	5/32" x 1/2"
FL-886882	5/32" x 9/16"

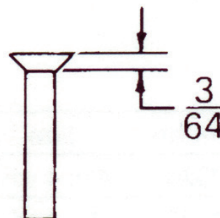

RIVETS AND BURRS

SPEEDY RIVETS

Nickel Plated Steel.

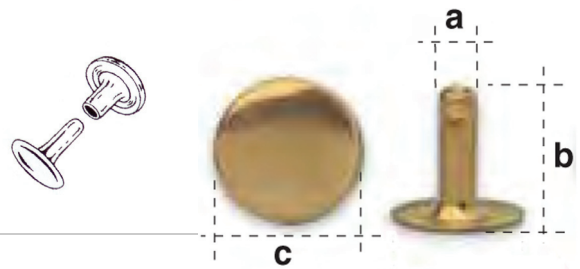

1000 UNITS PER BOX

Reference	Stud Dia. (a)	Stud Length (b)	Cap Dia. (c)	Color	Heads	Punch Hole Dia.
AC-280040522	2.2 MM	5 MM	4 MM	Nickel Plated	Single	2.5 MM
AC-280060723	2.3 MM	7 MM	6 MM	Nickel Plated	Single	2.5 MM
AC-280070829	2.9 MM	8 MM	7 MM	Nickel Plated	Single	3 MM
AC-280090829	2.9 MM	8 MM	9 MM	Nickel Plated	Single	3 MM
AC-280090929	2.9 MM	9 MM	9 MM	Nickel Plated	Single	3 MM
AC-280111131	3.1 MM	11 MM	11 MM	Nickel Plated	Single	3.5 MM
AC-280111231	3.1 MM	12 MM	11 MM	Nickel Plated	Single	3.5 MM
AC-280111331	3.1 MM	13 MM	11 MM	Nickel Plated	Single	3.5 MM
AC-280111534	3.4 MM	15 MM	11 MM	Nickel Plated	Single	3.5 MM
AC-280131234	3.4 MM	12 MM	13 MM	Nickel Plated	Single	3.5 MM
AC-280131845	4.5 MM	18 MM	13 MM	Nickel Plated	Single	5 MM
AC-280151233	3.3 MM	12 MM	15 MM	Nickel Plated	Single	3.5 MM
AC-281070829	2.9 MM	8 MM	07 MM	Black	Single	3 MM
AC-281090929	2.9 MM	9 MM	09 MM	Black	Single	3 MM
AC-281111131	3.1 MM	11 MM	11 MM	Black	Single	3.5 MM
AC-282070929	2.9 MM	9 MM	7 MM	Nickel Plated	Double	3 MM
AC-282111031	3.1 MM	10 MM	11 MM	Nickel Plated	Double	3.5 MM
AC-282111231	3.1 MM	12 MM	11 MM	Nickel Plated	Double	3.5 MM

RUST PROOF SPEEDY RIVETS

Brass, nickel plated.

1000 UNITS PER BOX

Reference	Stud Dia. (a)	Stud Length (b)	Cap Dia. (c)	Color	Heads	Punch Hole Dia.
AC-283070829	2.9 MM	8 MM	7 MM	Nickel Plated	Single	3 MM
AC-283090829	2.9 MM	8 MM	9 MM	Nickel Plated	Single	3 MM
AC-283111131	3.1 MM	11 MM	11 MM	Nickel Plated	Single	3.5 MM
AC-283131234	3.4 MM	12 MM	13 MM	Nickel Plated	Single	3.5 MM

RIVETS AND BURRS

STAINLESS STEEL RIVETS

Annealed.

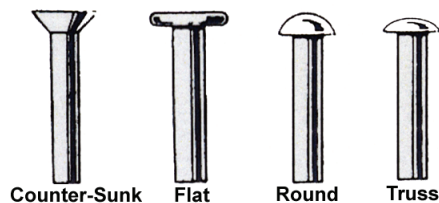

1000 UNITS PER BOX			
Reference	Stud Dia.	Stud Length	Head
FL-886871	5/32"	1/4"	Flat
FL-886872	5/32"	3/8"	Flat
FL-886873	5/32"	11/32"	Flat
FL-886870	1/8"	5/8"	Truss
FL-886876	3/16"	9/16"	Truss
BO-Z53234	5/32"	3/4"	Counter-Sunk
AC-R31638	5/32"	3/8"	Truss
AC-RHI-1	1/8"	1/4"	Round Head
BO-RTV-BL	5/32"	5/8"	Counter-Sunk

RIVETS AND BURRS

NYLOPLEX STUD RIVETS

1 UNIT PER PACK				
MEASUREMENTS (IN MM)				
Reference	A	B	C	D
FL-886801	6	3	9	4
FL-886802	10	3	9	4
FL-886805	10	6	15	5

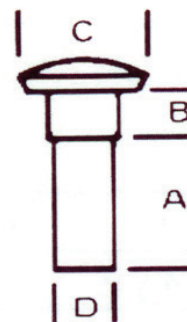

NYLOPLEX RIVETS WITHOUT HEAD



1 UNIT PER PACK		
MEASUREMENTS (IN MM)		
Reference	A	D
FL-886809	12	3
FL-886811	12	4
FL-886813	12	5

NYLOPLEX RIVETS WITH HEADS

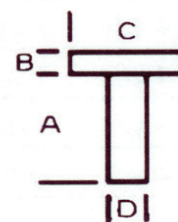

1 UNIT PER PACK				
MEASUREMENTS (IN MM)				
Reference	A	B	C	D
FS-886818	12	1.5	10	3
FS-886820	12	1.5	10	4
FS-886822	12	1.5	10	5
FS-886824	24	1.5	12	4

WASHERS FOR NYLOPLEX RIVETS

100 UNITS PER PACK	
Reference	Description
FS-885459	Flat Washer #6 for 3mm Rivet
FS-885467	Flat Washer #8 for 4mm Rivet
FS-885475	Flat Washer #10 for 5mm Rivet
FS-885483	Counter Sunk Washer #6 for 3mm Rivet
FS-885491	Counter Sunk Washer #8 for 4mm Rivet
FS-885509	Counter Sunk Washer #10 for 5mm Rivet